

Flange pressure transmitters

ATM/F

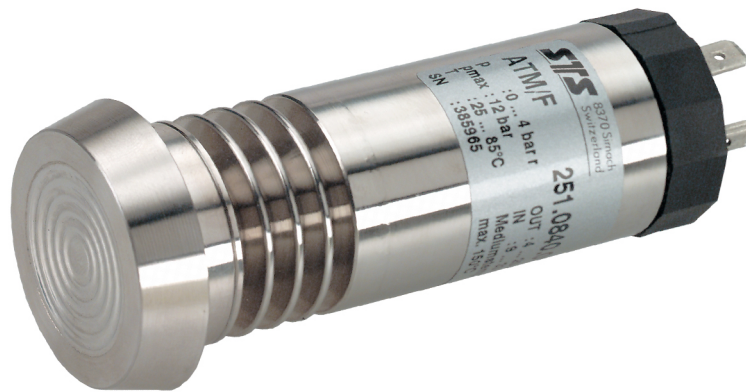

Version: 28.03.2012

Technical Specifications

Pressure measuring range (bar)

	0.1 ... 0.5	> 0.5 ... 2	> 2 ... 25
Overpressure	3 bar	3 x FS (≥ 3 bar)	3 x FS
Berstdruck	> 200 bar	> 200 bar	> 200 bar
Accuracy, (1), (± % FS)	≤ 0.5 / ≤ 0.25	≤ 0.5 / ≤ 0.25 / ≤ 0.1	≤ 0.5 / ≤ 0.25 / ≤ 0.1
Thermal shift, (± % FS/°C)			
Zero point 0...70°C	≤ 0.06	≤ 0.03	≤ 0.015
Zero point -25...85°C	≤ 0.08	≤ 0.04	≤ 0.02
Span 0...70°C	≤ 0.015	≤ 0.015	≤ 0.015
Span -25...85°C	≤ 0.02	≤ 0.02	≤ 0.02
Long term stability, (2)	< 0.5% FS / < 4 mbar	< 0.2% FS / < 4 mbar	< 0.1% FS / < 0.2% FS

(1) Zero based accuracy according to DIN16086, incl. hysteresis and repeatability at ambient temperature

(2) 1 year (typ. / max.)

Temperature range

Operating temperature	-25...85 °C
Process temperatur	-25...100 °C
Storage temperatur	-25...85 °C

Electrical specifications

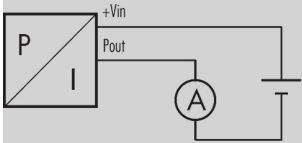
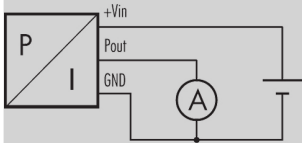
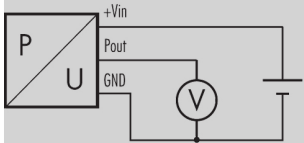
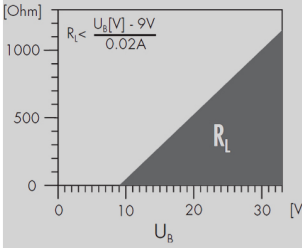
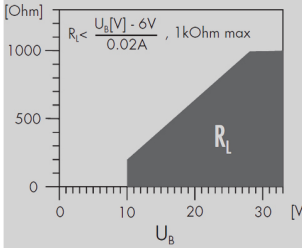
	4 ... 20 mA	0 ... 20 mA	0 ... 5 V / 0 ... 10 V
Power supply	9...33 V DC	9...33 V DC	15...30 V DC
Supply influence	< 0.1% FS	< 0.1% FS	< 0.1% FS
Current consumption			3 mA
Circuit diagram			
Load resistance			$R_L > 10k\Omega$
Load influence	< 0.1% FS	< 0.1% FS	< 0.1% FS

Qualifications

	Description	Level	Typical interferences
EN 61000-4-2	Electrostatic discharge	4 kV contact 8 kV air	
EN 61000-4-3	Irradiated RF	10V/m (0.08...1 GHz)	Radio sets, wireless phones
EN 61000-4-4	Transients (burst)	2 kV	Motors, valves
EN 61000-4-5	Surge	10 kA (8 / 20 μs), (1)	Lightning
EN 61000-4-6	Conducted RF	10 V (0.15...80 MHz)	Frequency converters

(1) Only with optional surge (lightning) protection

Physical specifications

Materials	
Transducer	Stainless steel (316L / 1.4435)
Housing	Stainless steel (316L / 1.4404)
Cable	PUR, PTFE, PE

(1) Hastelloy (C-276) on request

Accessories

Overview

Accessories overview	
10.00.0091	

Additional documents

Operating and safety instructions

Article number	
10.88.0092	DMM029

Ordering information

		X. XXXX.	XXXX.	XX.	XXX
Type					
	ATM/F	25			
Pressure type					
	Gauge	1			
	Absolute pressure (vacuum)	2			
Pressure measuring range					
	Any pressure measuring ranges between 0...100 mbar and 0...25 bar available	XX			
Process connection					
	Milk flange DN 25 - DIN 11851, (Fig. 1), (1)	30			
	Milk flange DN 40 - DIN 11851, (Fig. 2), (1)	31			
	Milk flange DN 50 - DIN 11851, (1)	32			
	Clamp 1", (Fig. 3)	40			
	Clamp 1 1/2", (Fig. 3)	41			
	DIN flange DN 25, PN 16	45			
	DIN flange DN 40	46			
	Customized connections available	XX			
Electrical connection					
	DIN 43650, demountable, IP 65, (Fig. 10), (2)		01		
	Binder 723, 5-pin, demountable, IP 67, (Fig. 12), (2)		43		
	MIL C26482, 10-6, IP 40, (Fig. 13), (2)		06		
	PE cable, IP 67, (Fig. 14), (3), (4)		13		
	PUR cable, IP 67, (Fig. 14), (3), (5)		15		
	PTFE cable, IP 67, (Fig. 14), (3)		21		
	Customized connection available		XX		
Output signal					
	4...20 mA		05		
	0...20 mA		00		
	0...5 V DC		46		
	0...10 V DC		47		
	4...20 mA with surge (lightning) protection		08		
	0...10 V DC with surge (lightning) protection		49		
Accuracy					
	≤ ± 0.5 % FS			0	
	≤ ± 0.25 % FS			1	
	≤ ± 0.1 % FS (on request)			2	
Temperature range					
	0...70 °C compensated (allowed process temperature: 0...80 °C)			0	
	-25...85 °C compensated (allowed process temperature: -25...100 °C)			1	
Option 1					
	Special oil filling: ASEOL Food (for food applications)				G
	Special oil filling: Halocarbon (for oxygen applications) (6)				H
Option 2					
	Electronics packed in gel: Gauge pressure				C
	Electronics packed in gel: Absolute pressure				D
Option 3					

(1) Nut included

- (2) Cable socket connector not included
- (3) Please specify the required cable length and medium
- (4) Suitable for drinking water (food approved)
- (5) For operating temperature $> 50^{\circ}\text{C}$, PE or PTFE cable must be used
- (6) min. Medium temperature -25°C

Technical drawings

Pressure connection

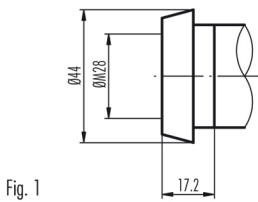

Fig. 1

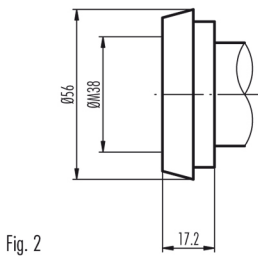

Fig. 2

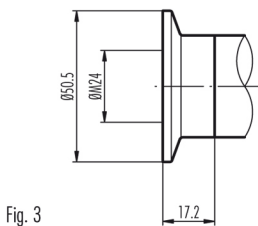
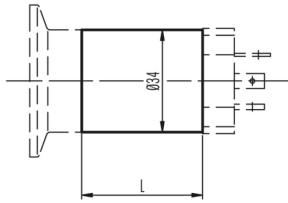

Fig. 3

Dimensions

Version for media temperature up to 100°C



L = 90 mm for version with surge (lightning) protection
L = 40 mm for all other versions

Version for media temperature >100°C up to 150°C

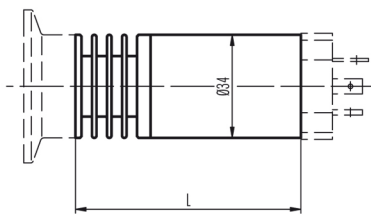

L = 125 mm for version with surge (lightning) protection
L = 75 mm for all other versions

Electrical connections

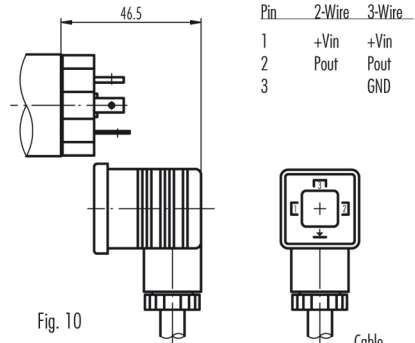

Fig. 10

Pin	2-Wire	3-Wire
1	+Vin	+Vin
2	Pout	Pout
3		GND

Cable socket connector

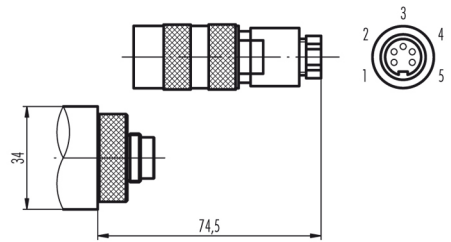

Fig. 12

Pin	2-Wire	3-Wire
1	Pout	Pout
3	+Vin	+Vin
4		GND

Cable socket connector

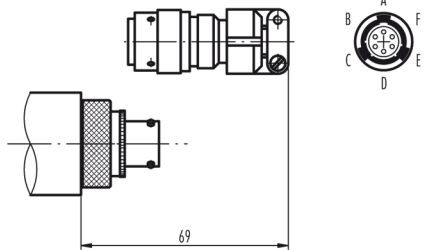

Fig. 13

Pin	2-Wire	3-Wire
A	+Vin	+Vin
B	Pout	Pout
C		GND

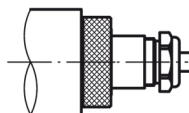

Fig. 14

Colour	2-Wire	3-Wire
white	+Vin	+Vin
yellow	Pout	GND
brown		Pout

Specifications may change without notice.

STS Great Britain:
STS Great Britain Ltd.
Higham Dairy Farm, Bumhill Lane, Alfreton | Derbyshire | Great Britain, DE55 6AH
contact@stssensors.com | www.stssensors.co.uk

STS Headquarters, Switzerland:
STS Sensor Technik Sirmach AG
Rüthofstrasse 8, 8370 Sirmach, Switzerland
sales@stssensors.com | www.stssensors.com

STS France:
STS France
844 Route de la Caille, 74350 Allonzier la Caille, France
info-fr@stssensors.com | www.stssensors.fr

STS Germany:
STS Sensoren Transmitter Systeme GmbH
Poststrasse 7, 71063 Sindelfingen, Germany
info-de@stssensors.com | www.stssensors.de

STS Italy:
STS Italia s.r.l.
Via Gesù 5, 20090 Opera (Milano), Italy
info-italia@stssensors.com | www.stssensors.it