

Pressure transmitters with ceramic measuring cell

ATM/K



Version: 28.03.2012

Technische Spezifikationen

Pressure measuring range (bar)

	0.1	0.2 / 0.4	1
Überlast	4 bar	6 bar	10 bar
Accuracy, (1), (\pm % FS)	≤ 0.25	≤ 0.25	≤ 0.25
Thermal shift, (\pm % FS/$^{\circ}$C)			
Zero point -20...80 $^{\circ}$ C	≤ 0.01	≤ 0.01	≤ 0.01
Span -20...80 $^{\circ}$ C	≤ 0.01	≤ 0.01	≤ 0.01
Long term stability, (2)	< 0.15 % FS	< 0.15 % FS	< 0.15 % FS

	2	4	10 / 20
Überlast	18 bar	25 bar	40 bar
Accuracy, (1), (\pm % FS)	≤ 0.25	≤ 0.25	≤ 0.25
Thermal shift, (\pm % FS/$^{\circ}$C)			
Zero point -20...80 $^{\circ}$ C	≤ 0.01	≤ 0.01	≤ 0.01
Span -20...80 $^{\circ}$ C	≤ 0.01	≤ 0.01	≤ 0.01
Long term stability, (2)	< 0.15 % FS	< 0.15 % FS	< 0.15 % FS

(1) Zero based accuracy according to DIN16086, incl. hysteresis and repeatability at ambient temperature

(2) 1 year (typ.)

Temperature range

Operating temperature	-25...85 $^{\circ}$ C
Process temperatur	-40...125 $^{\circ}$ C
Storage temperatur	-25...85 $^{\circ}$ C

Electrical specifications

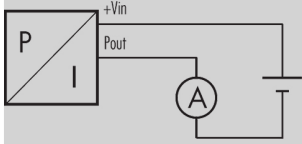
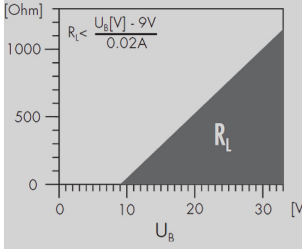
	4 ... 20 mA
Power supply, (1)	9...30 V DC
Supply influence	< 0.1% FS
Circuit diagram	
Load resistance	
Load influence	< 0.1% FS

(1) Power supply with optional surge (lightning) protection: 12...30 V DC

Qualifications

	Description	Level	Typical interferences
EN 61000-4-2	Electrostatic discharge	4 kV contact 8 kV air	
EN 61000-4-3	Irradiated RF	10V/m (0.08...1 GHz)	Radio sets, wireless phones
EN 61000-4-4	Transients (burst)	2 kV	Motors, valves
EN 61000-4-5, (1)	Surge	10 kA (8 / 20 µs)	Lightning
EN 61000-4-6	Conducted RF	10 V (0.15...80 MHz)	Frequency converters

(1) Only with optional surge (lightning) protection

Physikalische Spezifikationen

Materials	
Transducer	Ceramic Al ₂ O ₃ (96%)
Housing	Stainless steel (316L / 1.4404)
Seals	Viton (standard), EPDM, Kalrez

Equipment

Overview

10.00.0091	Accessories overview

Additional documents

Operating and safety instructions

	Article number
10.88.0092	DMM029

Ordering information

		X. XXXX.	XXXX.	XX.	XXX
Type					
	ATM/K	53			
Pressure type					
	Gauge	1			
	Absolute (vacuum)	2			
Pressure measuring range					
	0...100 mbar	00			
	0...200 mbar	40			
	0...400 mbar	03			
	0...1.0 bar	05			
	0...2.0 bar	41			
	0...4.0 bar	08			
	0...10 bar	10			
	0...20 bar	42			
Process connection					
	G 1/2 M, 10mm bore (Fig. 2)	13			
	Customized connections available	XX			
Electrical connection					
	DIN 43650, demountable, IP 65, (Fig. 10), (1)		01		
	Binder 723, 5-pin, demountable, IP 67, (Fig. 12), (1)		43		
	Customized connection available		XX		
Output signal					
	4...20 mA		05		
	4...20 mA surge (lightning) protection		08		
Accuracy					
	$\leq \pm 0.25$ % FS			1	
Temperature range					
	-20...80 °C compensated (allowed process temperature: -40...125 °C)			3	
Option 1					
Option 2					
Option 3					

(1) Cable socket connector not included

Technical drawings

Pressure connections / Dimensions

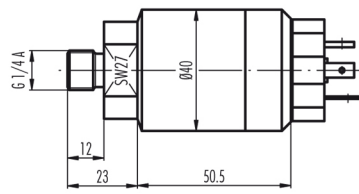

Fig. 1

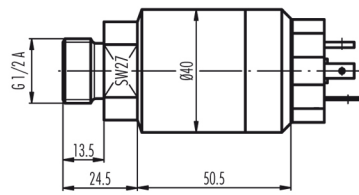

Fig. 2

Electrical connections

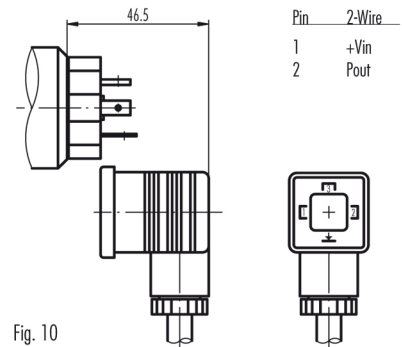

Fig. 10

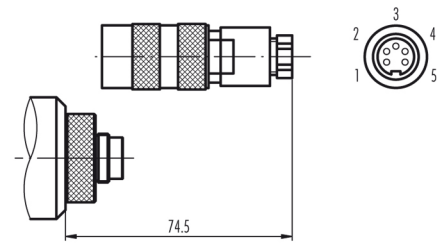

Fig. 12

Specifications may change without notice.

STG Great Britain:

STG Great Britain Ltd.
Higham Dairy Farm, Bumhill Lane, Alfreton | Derbyshire | Great Britain, DE55 6AH
contact@stssensors.com | www.stssensors.co.uk

STG Headquarters, Switzerland:

STG Sensor Technik Sirmach AG
Rüthofstrasse 8, 8370 Sirmach, Switzerland
sales@stssensors.com | www.stssensors.com

STG France:

STG France
844 Route de la Caille, 74350 Allonzier la Caille, France
info-fr@stssensors.com | www.stssensors.fr

STG Germany:

STG Sensoren Transmitter Systeme GmbH
Poststrasse 7, 71063 Sindelfingen, Germany
info-de@stssensors.com | www.stssensors.de

STG Italy:

STG Italia s.r.l.
Via Gesù 5, 20090 Opera (Milano), Italy
info-italia@stssensors.com | www.stssensors.it